

Request for Proposals
Alameda Corridor

Maintenance of Way Services

APPENDIX M

***Division of Maintenance
Responsibility***

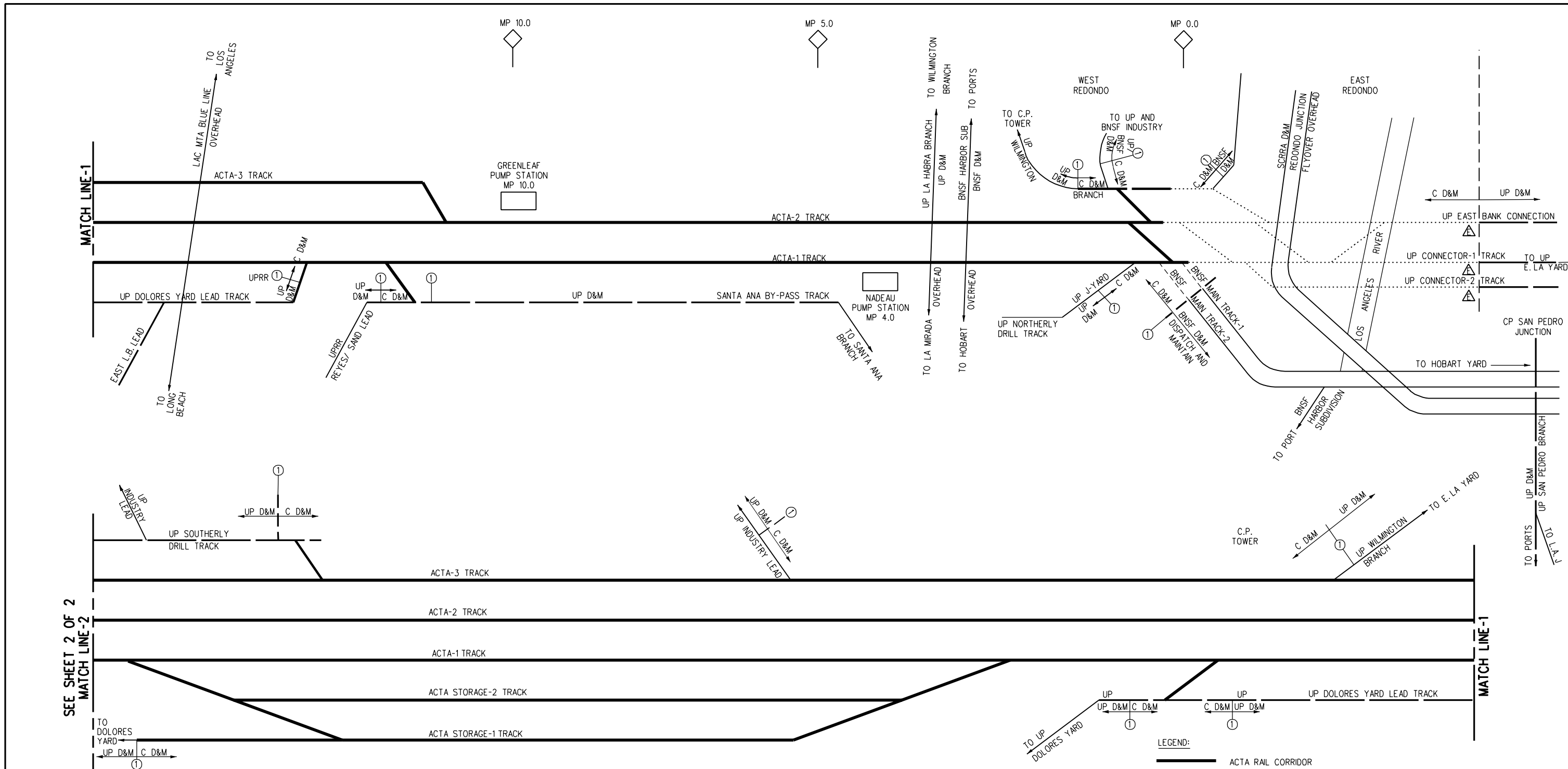

NOTE:
 THIS SCHEMATIC DOES NOT SHOW THE EXACT CROSSOVER AND TURNOUT CONFIGURATION. REFER TO THE TRACK CHARTS (EXHIBIT "D") FOR THE EXACT LOCATIONS.

ABBREVIATIONS:
 C = CORRIDOR CONTRACTOR
 ACTA = ALAMEDA CORRIDOR TRANSPORTATION AUTHORITY
 UP = UNION PACIFIC RAILROAD
 BNSF = BURLINGTON NORTHERN SANTA FE RAILWAY
 PHL = PACIFIC HARBOR LINE
 MP = MILEPOST
 D = DISPATCH CONTROL
 M = MAINTENANCE RESPONSIBILITY

- LEGEND:**
- ACTA RAIL CORRIDOR
 - TRACKS ON PORT'S PROPERTY
 - OTHER TRACKS NOT ON PORT'S PROPERTY
 - INDICATES TRACK MAINTENANCE TO BE PAID FOR SEPARATELY BY UPRR.
 - △ AEI LOCATION OFF CORRIDOR ON PORT'S PROPERTY.
 - INDICATES TRACK MAINTENANCE TO BE PAID FOR SEPARATELY BY BNSF.
- ① BOUNDARY OF CORRIDOR DISPATCHER AND CORRIDOR MAINTENANCE CONTRACTOR RESPONSIBILITIES (RESPONSIBILITY REMAINS WITH SUCH ENTITIES THROUGH AND INCLUDING THE FIRST SIGNAL OFF OF THE RAIL CORRIDOR).
- ② BOUNDARY OF PHL DISPATCHING AND CORRIDOR MAINTENANCE CONTRACTOR RESPONSIBILITIES (RESPONSIBILITY REMAINS WITH SUCH ENTITIES THROUGH AND INCLUDING THE FIRST SIGNAL OFF OF THE RAIL CORRIDOR EXCEPT THAT PHL HAS MAINTENANCE RESPONSIBILITY AT CP BADGER).

REV	DATE	BY	SUB	APP	DESCRIPTION	REV	DATE	BY	SUB	APP	DESCRIPTION

DESIGNED BY
C. NITU

DRAWN BY
C. NITU

CHECKED BY
D.A. SEPULVEDA

IN CHARGE
D.A. SEPULVEDA

DATE
11 OCT 01

NOT APPLICABLE

ALAMEDA CORRIDOR TRANSPORTATION AUTHORITY

ALAMEDA CORRIDOR ENGINEERING TEAM
 Daniel, Mann, Johnson, & Mendenhall
 Moffatt & Nichol Engineers
 Jenkins-Gates & Martinez, Inc.
 TELACU

SUBMITTED _____

APPROVED _____

ALAMEDA CORRIDOR
 DISPATCH AND MAINTENANCE

TRACK SCHEMATIC
 SHEET 1 OF 2
 EXHIBIT A

CONTRACT NO.	MAINTENANCE AGREEMENT
DRAWING NO.	EXHIBIT A
SCALE	NO SCALE
SHEET NO.	1 OF 2

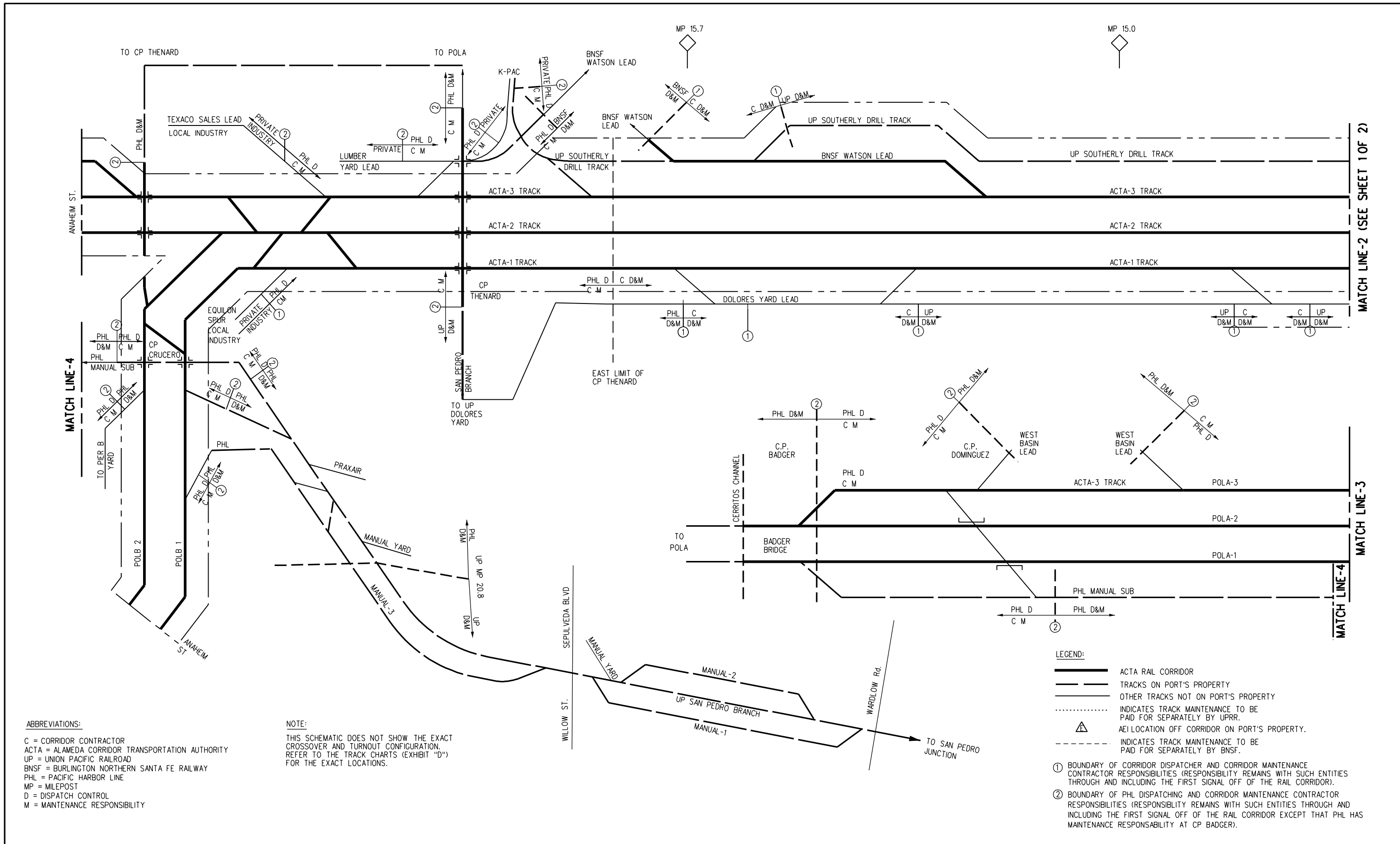

MATCH LINE-2 (SEE SHEET 1 OF 2)

MATCH LINE-3

MATCH LINE-4

ABBREVIATIONS:
 C = CORRIDOR CONTRACTOR
 ACTA = ALAMEDA CORRIDOR TRANSPORTATION AUTHORITY
 UP = UNION PACIFIC RAILROAD
 BNSF = BURLINGTON NORTHERN SANTA FE RAILWAY
 PHL = PACIFIC HARBOR LINE
 MP = MILEPOST
 D = DISPATCH CONTROL
 M = MAINTENANCE RESPONSIBILITY

NOTE:
 THIS SCHEMATIC DOES NOT SHOW THE EXACT CROSSOVER AND TURNOUT CONFIGURATION. REFER TO THE TRACK CHARTS (EXHIBIT "D") FOR THE EXACT LOCATIONS.

LEGEND:

- ACTA RAIL CORRIDOR
- TRACKS ON PORT'S PROPERTY
- OTHER TRACKS NOT ON PORT'S PROPERTY
- INDICATES TRACK MAINTENANCE TO BE PAID FOR SEPARATELY BY UPRR.
- AEI LOCATION OFF CORRIDOR ON PORT'S PROPERTY.
- INDICATES TRACK MAINTENANCE TO BE PAID FOR SEPARATELY BY BNSF.

① BOUNDARY OF CORRIDOR DISPATCHER AND CORRIDOR MAINTENANCE CONTRACTOR RESPONSIBILITIES (RESPONSIBILITY REMAINS WITH SUCH ENTITIES THROUGH AND INCLUDING THE FIRST SIGNAL OFF OF THE RAIL CORRIDOR).

② BOUNDARY OF PHL DISPATCHING AND CORRIDOR MAINTENANCE CONTRACTOR RESPONSIBILITIES (RESPONSIBILITY REMAINS WITH SUCH ENTITIES THROUGH AND INCLUDING THE FIRST SIGNAL OFF OF THE RAIL CORRIDOR EXCEPT THAT PHL HAS MAINTENANCE RESPONSIBILITY AT CP BADGER).

REV	DATE	BY	SUB	APP	DESCRIPTION	REV	DATE	BY	SUB	APP	DESCRIPTION

DESIGNED BY
C. NITU

DRAWN BY
C. NITU

CHECKED BY
D.A. SEPULVEDA

IN CHARGE
D.A. SEPULVEDA

DATE
7 DEC 01

NOT APPLICABLE

ALAMEDA CORRIDOR TRANSPORTATION AUTHORITY

ALAMEDA CORRIDOR ENGINEERING TEAM
 Daniel, Mann, Johnson, & Mendenhall
 Moffatt & Nichol Engineers
 Jenkins-Gates & Martinez, Inc.
 TELACU

SUBMITTED _____

APPROVED _____

ALAMEDA CORRIDOR
 DISPATCH AND MAINTENANCE
 TRACK SCHEMATIC
 SHEET 2 OF 2
 EXHIBIT A

CONTRACT NO. MAINTENANCE AGREEMENT	
DRAWING NO. EXHIBIT A	REV P
SCALE NO SCALE	
SHEET NO. 2 OF 2	